

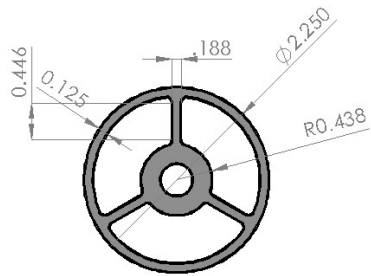

Front

Top



## Description

The Stand-Off Post is a lightweight stand-off made from aluminum and is available in 3 standard lengths. The post is tapped on both the top and bottom to a depth of 2" to receive a 3/8" - 16 threaded bolt. The base of the post has drainage holes to ensure water is retained within the post.

## Testing, Approvals and Listings

The U-Anchor Stand-Off Post was tested in conjunction with each of the U-Anchor attachment solutions

ASCE 7-05 ASTM E330-02 (2010) TAS 117B.

*Test Reports can be requested on-line or through your distributor.*

## Options and Packaging

- 2" Stand-off
- 4" Stand-off
- 6" Stand-off
- Custom\* lengths available

2-2/4" diameter provides greater support for L - brackets and other rooftop equipment.

## Packaging Specs

- Units sold individually

Custom options may be available for additional charge. Lead times may apply depending on roofing manufacturer and product availability.

*Revised Version: 08.06.20*