

# U-Anchor 2400 EPDM

## Installation Instructions:

*\*These instructions are for EPDM ballasted, mechanically attached, or fully adhered roof systems.*

### Before You Start:

Inspect the existing roof with a qualified professional to ensure that it is in good condition and meets local codes and manufacturer's warranty requirements.

### Layout:

Appropriate frequency and spacing of the attachment points should be determined by a qualified professional for seismic requirements, compressive strength of the roofing assembly, structural load capacity, and local building code requirements. Convey the designed layout onto the roof surface, creating crosshatches. Pair the alignment marks on each side of the U-Anchor with the crosshatches previously prepared on the roof surface. Clean the surface where U-Anchor 2400 will be adhered to the roof with a manufacturer approved cleaner.

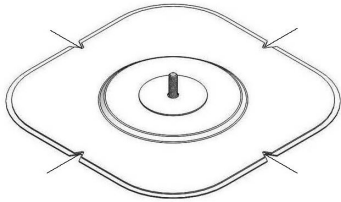

**Step 1:** Apply the EPDM primer to the surface of the roof and fasten the plate to deck with approved fasteners.

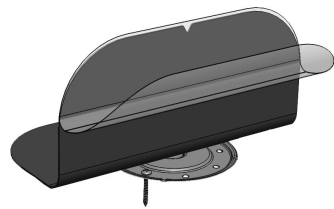

**Step 2:** Once properly aligned and the primer is dry to the touch, remove half of the release liner and, with your hand pressing down firmly, adhere the EPDM to the surface without any wrinkles or air pockets. Repeat with the other half of the target.

**Step 3:** With a 2" inch wide roller, roll the target to achieve proper bonding to the roof. Apply seam sealant, if needed, in accordance with roof manufacturer's instructions.

*(Prior to adhering the Anchor mount into place, be sure the placement is accurate)*

Install ancillary components using a stainless steel 3/8"-16 nut and lock washer. The recommended torque for the U-Anchor 2400 is 20\25 ft lbs.

