

Product Data Sheet: U-Anchor 2000 EPDM Double Sided Adhesive™

For use with the U-Anchor 2000 over EPDM roof membranes

Product Description:

The U-Anchor 2000 EPDM Double Sided Adhesive is used to adhere the U-Anchor 2000 Target to the EPDM roof membrane. The die cut Double Sided Adhesive is installed consistent with standard EPDM roof membrane practices and is accepted by roof manufacturers.

Advantages:

- * Lightweight: 5oz (142grams)
- * Die cut design eliminates seam tape splices
- * Accepted by roof membrane manufacturers

Packaging:

Included with the purchase of the U-Anchor 2000 EPDM and U-Anchor 2000 EPDM with Membrane Attachment Ring.

Units Sold Individually

Full box quantities: 10 units

Attachment:

The bottom surface of the U-Anchor 2000 Cover and the roof membrane must be cleaned and primed with compatible cleaners and primers. Once properly prepared the U-Anchor 2000 EPDM Double Sided Adhesive is used to adhere the U-Anchor 2000 Cover to the EPDM roof membrane.

Testing, Approvals and Listings:

The U-Anchor 2000 EPDM Double Sided Adhesive was tested in conjunction with each of the U-Anchor 2000 EPDM attachment solutions and in accordance with ASCE 7-05 ASTM E330-02 (2010) TAS 117B. Test reports can be requested on-line or through your distributor.

Warranty:

10 year standard material warranty

Up to 20 year material warranty available

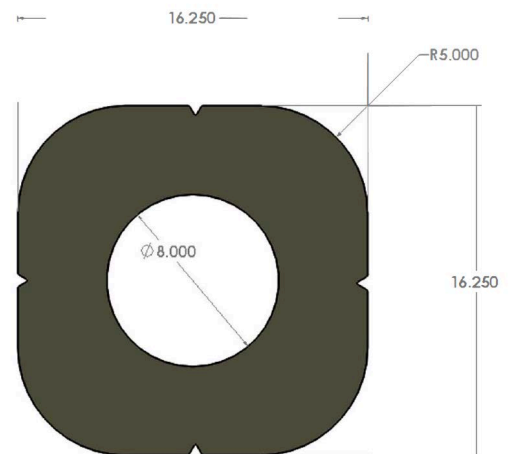
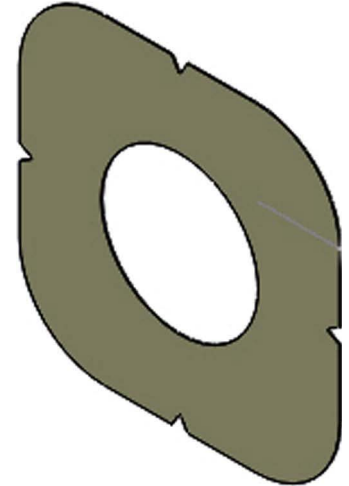

**ANCHOR
PRODUCTS™**



P.O. Box 1551
Colleyville, TX 76034
Info@anchorp.com

888-575-2131
www.anchorp.com



Patent: Search "Plate"
at www.Vmarked.com