

Product Data Sheet: U-Anchor 2600 APP Torch™

Provides a positive attachment of the U-Anchor 2600 APP Torch for Built-up and APP roof systems

Product Description:

The **U-Anchor 2600 APP Torch** is a lightweight rooftop attachment system consisting of a 5.5" U-Anchor Plate with a 3/8"-16 x 1-3/8" tall stainless steel stud. The U-Anchor 2600 APP Torch includes a factory prepared APP cover that is torched over the U-Anchor Plate and is sealed using traditional torch down methods.

The product with 1000 uses!

Advantages:

- * Lightweight: 24 oz. (680 grams)
- * Installs quickly, approximate rate of 12 per man hour.
- * Installs on any surface from flat to vertical.

Packaging:

Units sold individually

Full box quantities: 10 units

Unit components packaged separately

Attachment:

The U-Anchor 2600 APP Torch is attached by fastening through the roofing assembly into the structural decking with approved fasteners.

Testing, Approvals and Listings:

The U-Anchor 2600 APP Torch was tested in accordance with: ASCE 7-05 ASTM E330-02 (2010) TAS 117B. Testing can be requested on-line or through your distributor.

Warranty:

10 year standard material warranty

Up to 20 year material warranty available .

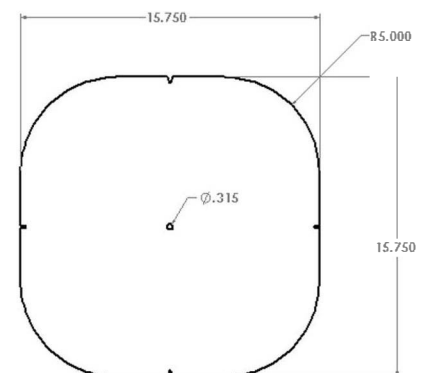
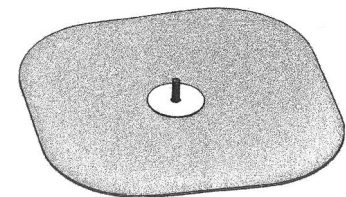
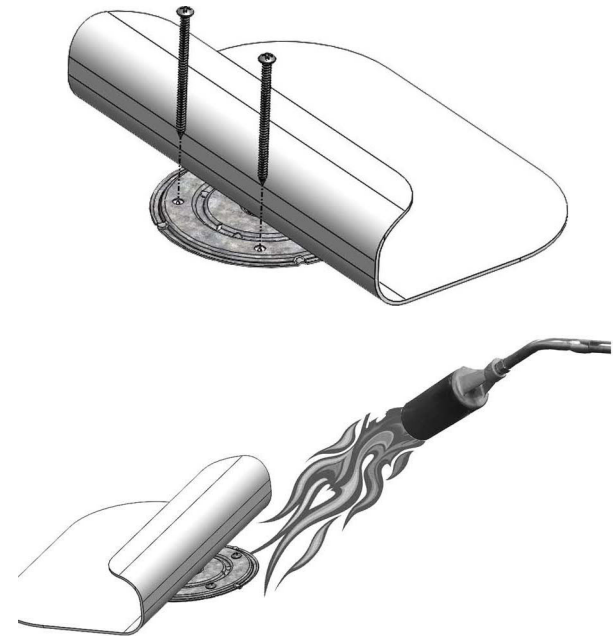

 Anchor Products™

P.O. Box 1551
Colleyville, TX 76034
Info@anchorp.com

888-575-2131
www.anchorp.com



Patent: Search "Plate"
at www.Vmarked.com